

Office of the County Executive

Monroe County, New York

Adam J. Bello
County Executive

May 6, 2022

OFFICIAL FILE COPY
No. <u>220172</u>
Not to be removed from the Office of the Legislature Of Monroe County
Committee Assignment
ENV. & PUB. WORKS-L

To The Honorable
Monroe County Legislature
407 County Office Building
Rochester, New York 14614

Subject: Classification of Action and Determination of Significance Pursuant to State Environmental Quality Review Act ("SEQRA") for the Archer Road Sidewalk Project funded through the Monroe County Community Development Block Grant Program /HOME

Honorable Legislators:

I recommend that Your Honorable Body designate Monroe County as Lead Agency for the Archer Road Sidewalk Project funded through the Monroe County Community Development Block Grant ("CDBG") Program and to determine whether the action may have a significant adverse impact on the environment pursuant to SEQRA.

This project consists of the Town of Chili using CDBG funds to install approximately 1,400 linear feet of ADA Compliant 5-foot wide sidewalks on Archer Road. The installation will occur in a suburban-residential neighborhood that was previously disturbed at the time of construction.

This project will not impact existing wetlands, or historical, cultural, or natural resources nor will it alter the existing community character. The proposed action is consistent with existing land use and will increase the safety of nearby residents.

Archer Road Sidewalk Project, funded through the Monroe County CDBG Program has been preliminarily classified as an Unlisted Action pursuant to 6 NYCRR § 617(b). The State Environmental Quality Review Act regulations found at 6 NYCRR Part 617 requires that no agency shall carry out or approve an Action until it has complied with the requirements of SEQRA.

The specific legislative actions required are:

1. Determine that Archer Road Sidewalk Project is an Unlisted Action.
2. Make a determination of significance of the Archer Road Sidewalk Project pursuant to 6 NYCRR § 617.7.
3. Authorize the County Executive, or his designee, to take such actions to comply with the requirements of SEQRA, including without limitation, the execution of documents and the filing, distribution and publication of the documents required under SEQRA, and any other actions to implement the intent of this resolution.

This determination will have no impact on the revenues or expenditures of the current Monroe County budget.

I recommend that this matter be referred to the appropriate committee(s) for favorable action by Your Honorable Body.

Sincerely,

Adam J. Bello
Monroe County Executive

AJB:db

Short Environmental Assessment Form

Part 1 - Project Information

Instructions for Completing

Part 1 – Project Information. The applicant or project sponsor is responsible for the completion of Part 1. Responses become part of the application for approval or funding, are subject to public review, and may be subject to further verification. Complete Part 1 based on information currently available. If additional research or investigation would be needed to fully respond to any item, please answer as thoroughly as possible based on current information.

Complete all items in Part 1. You may also provide any additional information which you believe will be needed by or useful to the lead agency; attach additional pages as necessary to supplement any item.

Part 1 – Project and Sponsor Information			
Town of Chili			
Name of Action or Project:			
Archer Road Sidewalk Extension			
Project Location (describe, and attach a location map):			
Archer Road			
Brief Description of Proposed Action:			
The project is located on the west side of Archer Road and will extend south from the intersection of Archer Road and Paul Road to a point at the north property line of a Town owned parcel located at 177 Archer Road. The area will benefit from the project by providing safe public access, that is ADA compliant, to the residents of the Archer Road corridor and providing a linkage between existing sidewalk networks.			
Name of Applicant or Sponsor:		Telephone: 585-889-6180	
David P. Lindsay, P.E.		E-Mail: dlindsay@townofchili.org	
Address:			
200 Beaver Road			
City/PO:		State:	Zip Code:
Churchville		New York	14428
1. Does the proposed action only involve the legislative adoption of a plan, local law, ordinance, administrative rule, or regulation?			
If Yes, attach a narrative description of the intent of the proposed action and the environmental resources that may be affected in the municipality and proceed to Part 2. If no, continue to question 2.			
2. Does the proposed action require a permit, approval or funding from any other government Agency?			
If Yes, list agency(s) name and permit or approval:			
3. a. Total acreage of the site of the proposed action?			0.17 acres
b. Total acreage to be physically disturbed?			0.17 acres
c. Total acreage (project site and any contiguous properties) owned or controlled by the applicant or project sponsor?			0.17 acres
4. Check all land uses that occur on, are adjoining or near the proposed action:			
5. <input type="checkbox"/> Urban <input type="checkbox"/> Rural (non-agriculture) <input type="checkbox"/> Industrial <input type="checkbox"/> Commercial <input checked="" type="checkbox"/> Residential (suburban)			
<input type="checkbox"/> Forest <input type="checkbox"/> Agriculture <input type="checkbox"/> Aquatic <input checked="" type="checkbox"/> Other(Specify): Open Space Area			
<input type="checkbox"/> Parkland			

5. Is the proposed action,	NO	YES	N/A
a. A permitted use under the zoning regulations?	<input type="checkbox"/>	<input type="checkbox"/>	<input checked="" type="checkbox"/>
b. Consistent with the adopted comprehensive plan?	<input type="checkbox"/>	<input checked="" type="checkbox"/>	<input type="checkbox"/>
6. Is the proposed action consistent with the predominant character of the existing built or natural landscape?	NO	YES	
	<input type="checkbox"/>	<input checked="" type="checkbox"/>	
7. Is the site of the proposed action located in, or does it adjoin, a state listed Critical Environmental Area?	NO	YES	
If Yes, identify: _____	<input checked="" type="checkbox"/>	<input type="checkbox"/>	
8. a. Will the proposed action result in a substantial increase in traffic above present levels?	NO	YES	
	<input checked="" type="checkbox"/>	<input type="checkbox"/>	
b. Are public transportation services available at or near the site of the proposed action?	<input type="checkbox"/>	<input checked="" type="checkbox"/>	
c. Are any pedestrian accommodations or bicycle routes available on or near the site of the proposed action?	<input type="checkbox"/>	<input checked="" type="checkbox"/>	
9. Does the proposed action meet or exceed the state energy code requirements?	NO	YES	
If the proposed action will exceed requirements, describe design features and technologies:			
Sidewalk Construction Only _____	<input type="checkbox"/>	<input checked="" type="checkbox"/>	
10. Will the proposed action connect to an existing public/private water supply?	NO	YES	
If No, describe method for providing potable water: _____	<input checked="" type="checkbox"/>	<input type="checkbox"/>	
11. Will the proposed action connect to existing wastewater utilities?	NO	YES	
If No, describe method for providing wastewater treatment: _____	<input checked="" type="checkbox"/>	<input type="checkbox"/>	
12. a. Does the project site contain, or is it substantially contiguous to, a building, archaeological site, or district which is listed on the National or State Register of Historic Places, or that has been determined by the Commissioner of the NYS Office of Parks, Recreation and Historic Preservation to be eligible for listing on the State Register of Historic Places?	NO	YES	
	<input checked="" type="checkbox"/>	<input type="checkbox"/>	
b. Is the project site, or any portion of it, located in or adjacent to an area designated as sensitive for archaeological sites on the NY State Historic Preservation Office (SHPO) archaeological site inventory?	<input type="checkbox"/>	<input checked="" type="checkbox"/>	
13. a. Does any portion of the site of the proposed action, or lands adjoining the proposed action, contain wetlands or other waterbodies regulated by a federal, state or local agency?	NO	YES	
	<input type="checkbox"/>	<input checked="" type="checkbox"/>	
b. Would the proposed action physically alter, or encroach into, any existing wetland or waterbody?	<input checked="" type="checkbox"/>	<input type="checkbox"/>	
If Yes, identify the wetland or waterbody and extent of alterations in square feet or acres: _____			

14. Identify the typical habitat types that occur on, or are likely to be found on the project site. Check all that apply: <input type="checkbox"/> Shoreline <input type="checkbox"/> Forest <input type="checkbox"/> Agricultural/grasslands <input type="checkbox"/> Early mid-successional <input type="checkbox"/> Wetland <input type="checkbox"/> Urban <input checked="" type="checkbox"/> Suburban		
15. Does the site of the proposed action contain any species of animal, or associated habitats, listed by the State or Federal government as threatened or endangered?	NO	YES
	<input checked="" type="checkbox"/>	<input type="checkbox"/>
16. Is the project site located in the 100-year flood plan?	NO	YES
	<input checked="" type="checkbox"/>	<input type="checkbox"/>
17. Will the proposed action create storm water discharge, either from point or non-point sources? If Yes,	NO	YES
a. Will storm water discharges flow to adjacent properties?	<input checked="" type="checkbox"/>	<input type="checkbox"/>
b. Will storm water discharges be directed to established conveyance systems (runoff and storm drains)?	<input type="checkbox"/>	<input checked="" type="checkbox"/>
If Yes, briefly describe: _____ Minor increases in stormwater from impervious area added will be directed to Town right of way conveyance system		
18. Does the proposed action include construction or other activities that would result in the impoundment of water or other liquids (e.g., retention pond, waste lagoon, dam)? If Yes, explain the purpose and size of the impoundment: _____	NO	YES
	<input checked="" type="checkbox"/>	<input type="checkbox"/>
19. Has the site of the proposed action or an adjoining property been the location of an active or closed solid waste management facility? If Yes, describe: _____	NO	YES
	<input checked="" type="checkbox"/>	<input type="checkbox"/>
20. Has the site of the proposed action or an adjoining property been the subject of remediation (ongoing or completed) for hazardous waste? If Yes, describe: _____	NO	YES
	<input checked="" type="checkbox"/>	<input type="checkbox"/>
I CERTIFY THAT THE INFORMATION PROVIDED ABOVE IS TRUE AND ACCURATE TO THE BEST OF MY KNOWLEDGE		
Applicant/sponsor/name: <u>David P. Lindsay</u> Date: <u>2/5/2022</u>		
Signature: <u></u> Title: <u>Community Liaison</u>		

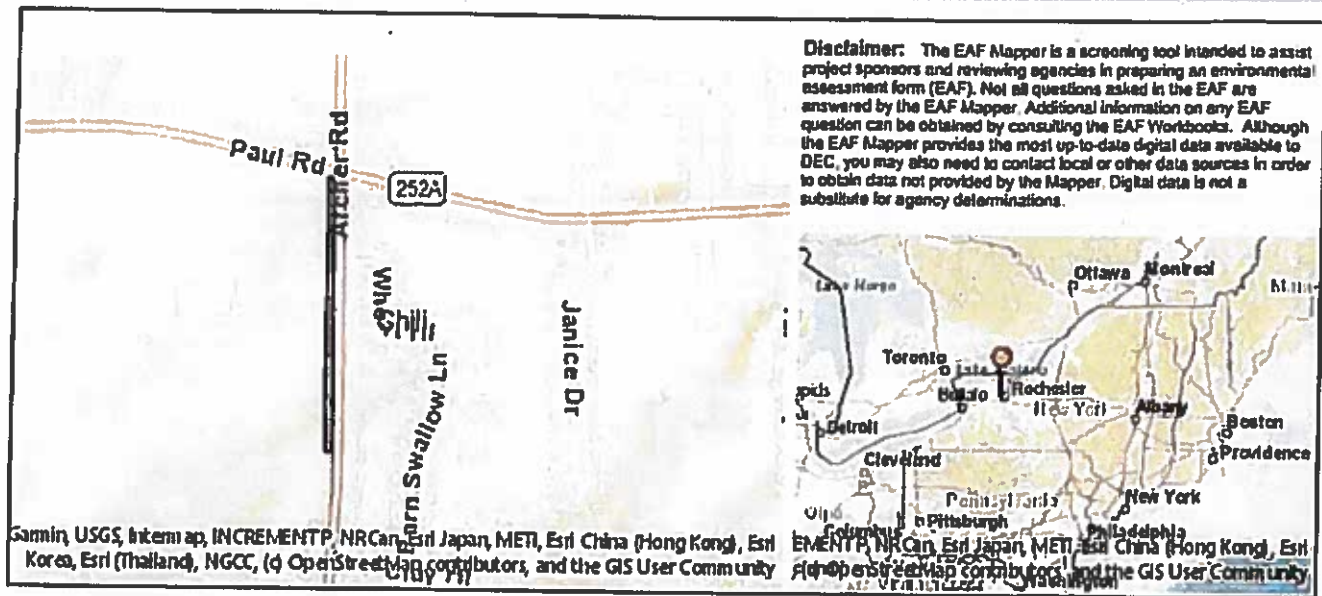

Part 1 / Question 7 [Critical Environmental Area]	No
Part 1 / Question 12a [National or State Register of Historic Places or State Eligible Sites]	No
Part 1 / Question 12b [Archeological Sites]	Yes
Part 1 / Question 13a [Wetlands or Other Regulated Waterbodies]	Yes - Digital mapping information on local and federal wetlands and waterbodies is known to be incomplete. Refer to EAF Workbook.
Part 1 / Question 15 [Threatened or Endangered Animal]	No
Part 1 / Question 16 [100 Year Flood Plain]	No
Part 1 / Question 20 [Remediation Site]	No

Project: Date:

Short Environmental Assessment Form

Part 2 - Impact Assessment

Part 2 is to be completed by the Lead Agency.

Answer all of the following questions in Part 2 using the information contained in Part 1 and other materials submitted by the project sponsor or otherwise available to the reviewer. When answering the questions the reviewer should be guided by the concept "Have my responses been reasonable considering the scale and context of the proposed action?"

	No, or small impact may occur	Moderate to large impact may occur
1. Will the proposed action create a material conflict with an adopted land use plan or zoning regulations?	<input checked="" type="checkbox"/>	<input type="checkbox"/>
2. Will the proposed action result in a change in the use or intensity of use of land?	<input checked="" type="checkbox"/>	<input type="checkbox"/>
3. Will the proposed action impair the character or quality of the existing community?	<input checked="" type="checkbox"/>	<input type="checkbox"/>
4. Will the proposed action have an impact on the environmental characteristics that caused the establishment of a Critical Environmental Area (CEA)?	<input checked="" type="checkbox"/>	<input type="checkbox"/>
5. Will the proposed action result in an adverse change in the existing level of traffic or affect existing infrastructure for mass transit, biking or walkway?	<input checked="" type="checkbox"/>	<input type="checkbox"/>
6. Will the proposed action cause an increase in the use of energy and it fails to incorporate reasonably available energy conservation or renewable energy opportunities?	<input checked="" type="checkbox"/>	<input type="checkbox"/>
7. Will the proposed action impact existing:	<input checked="" type="checkbox"/>	<input type="checkbox"/>
a. public / private water supplies?	<input checked="" type="checkbox"/>	<input type="checkbox"/>
b. public / private wastewater treatment utilities?	<input checked="" type="checkbox"/>	<input type="checkbox"/>
8. Will the proposed action impair the character or quality of important historic, archaeological, architectural or aesthetic resources?	<input checked="" type="checkbox"/>	<input type="checkbox"/>
9. Will the proposed action result in an adverse change to natural resources (e.g., wetlands, waterbodies, groundwater, air quality, flora and fauna)?	<input checked="" type="checkbox"/>	<input type="checkbox"/>
10. Will the proposed action result in an increase in the potential for erosion, flooding or drainage problems?	<input checked="" type="checkbox"/>	<input type="checkbox"/>
11. Will the proposed action create a hazard to environmental resources or human health?	<input checked="" type="checkbox"/>	<input type="checkbox"/>

Project: Date:

Short Environmental Assessment Form

Part 3 Determination of Significance

For every question in Part 2 that was answered "moderate to large impact may occur", or if there is a need to explain why a particular element of the proposed action may or will not result in a significant adverse environmental impact, please complete Part 3. Part 3 should, in sufficient detail, identify the impact, including any measures or design elements that have been included by the project sponsor to avoid or reduce impacts. Part 3 should also explain how the lead agency determined that the impact may or will not be significant. Each potential impact should be assessed considering its setting, probability of occurring, duration, irreversibility, geographic scope and magnitude. Also consider the potential for short-term, long-term and cumulative impacts.

Negative Declaration - Determination of No Significant Effect on the Environment:

The Town of Chili will install approximately 1,400 LF of concrete sidewalk along the west side of Archer Road from the terminus of a section of new sidewalk south to a point on of connection with a Town owned parcel located at 177 Archer Road. The project would provide a needed ADA compliant connection for pedestrians wishing travel from residential areas to the commercial core and Town facilities located along Chili Avenue. The project may disturb more than 4000 sf of land, but does not impact wetlands, the 100 year floodplain or any structures more than 50 years old. The new sidewalks will benefit the residents by improving the overall safety for those who walk frequently in the area. The project will not impact existing natural resources, wetlands, historical or cultural resources and will not alter the existing community character or increase traffic. The proposed action is consistent with existing land use. Accordingly, the proposed action will have no significant effect upon the environment and is determined to be a negative determination.

<input type="checkbox"/>	Check this box if you have determined, based on the information and analysis above, and any supporting documentation, that the proposed action may result in one or more potentially large or significant adverse impacts and an environmental impact statement is required.
<input checked="" type="checkbox"/>	Check this box if you have determined, based on the information and analysis above, and any supporting documentation, that the proposed action will not result in any significant adverse environmental impacts.
<div style="display: flex; justify-content: space-between;"> <div style="width: 45%;"> <p>Monroe County</p> <hr/> <p style="text-align: center;">Name of Lead Agency</p> <p>Adam J. Bello</p> <hr/> <p style="text-align: center;">Print or Type Name of Responsible Officer in Lead Agency</p> <hr/> <p style="text-align: center;">Signature of Responsible Officer in Lead Agency</p> </div> <div style="width: 45%;"> <hr/> <p style="text-align: center;">Date</p> <hr/> <p style="text-align: center;">County Executive</p> <div style="display: flex; justify-content: space-between;"> <div style="width: 45%;"> <hr/> <p style="text-align: center;">Title of Responsible Officer</p> </div> <div style="width: 45%;"> <hr/> <p style="text-align: center;">Signature of Preparer (if different from Responsible Officer)</p> </div> </div> </div> </div>	

PRINT FORM

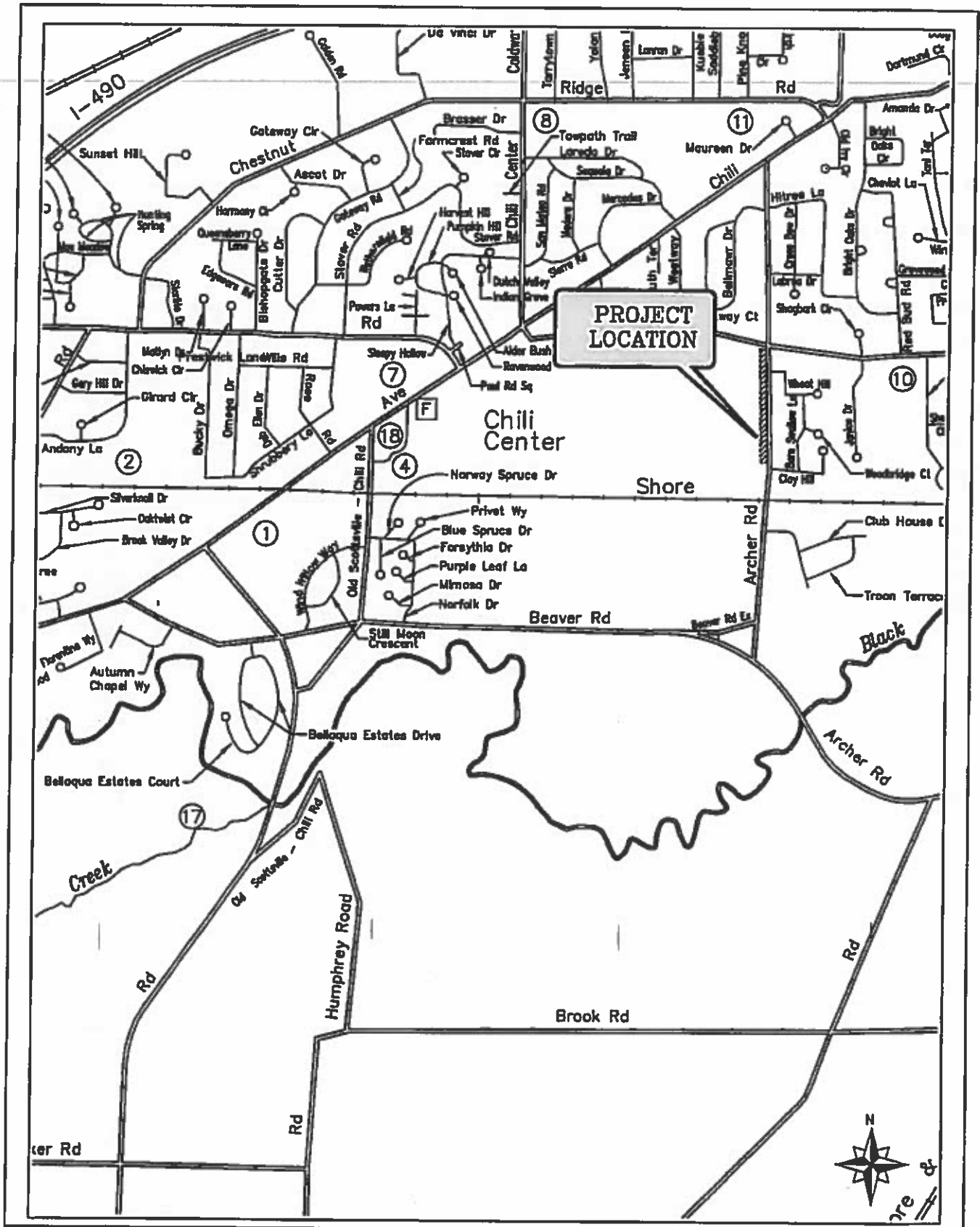

**ARCHER ROAD
CONCRETE SIDEWALK EXTENSION
CHILI, NEW YORK**

DATE: JAN. 2022

SCALE: N.T.S.

DRAWN BY: DPL

Chili Proj. No. 22-001