

HIGHLAND PARK

Park Office: 585-690-9988

for more information:
monroecounty.gov/parks
585-753-PARK (7275)



Monroe County
Parks

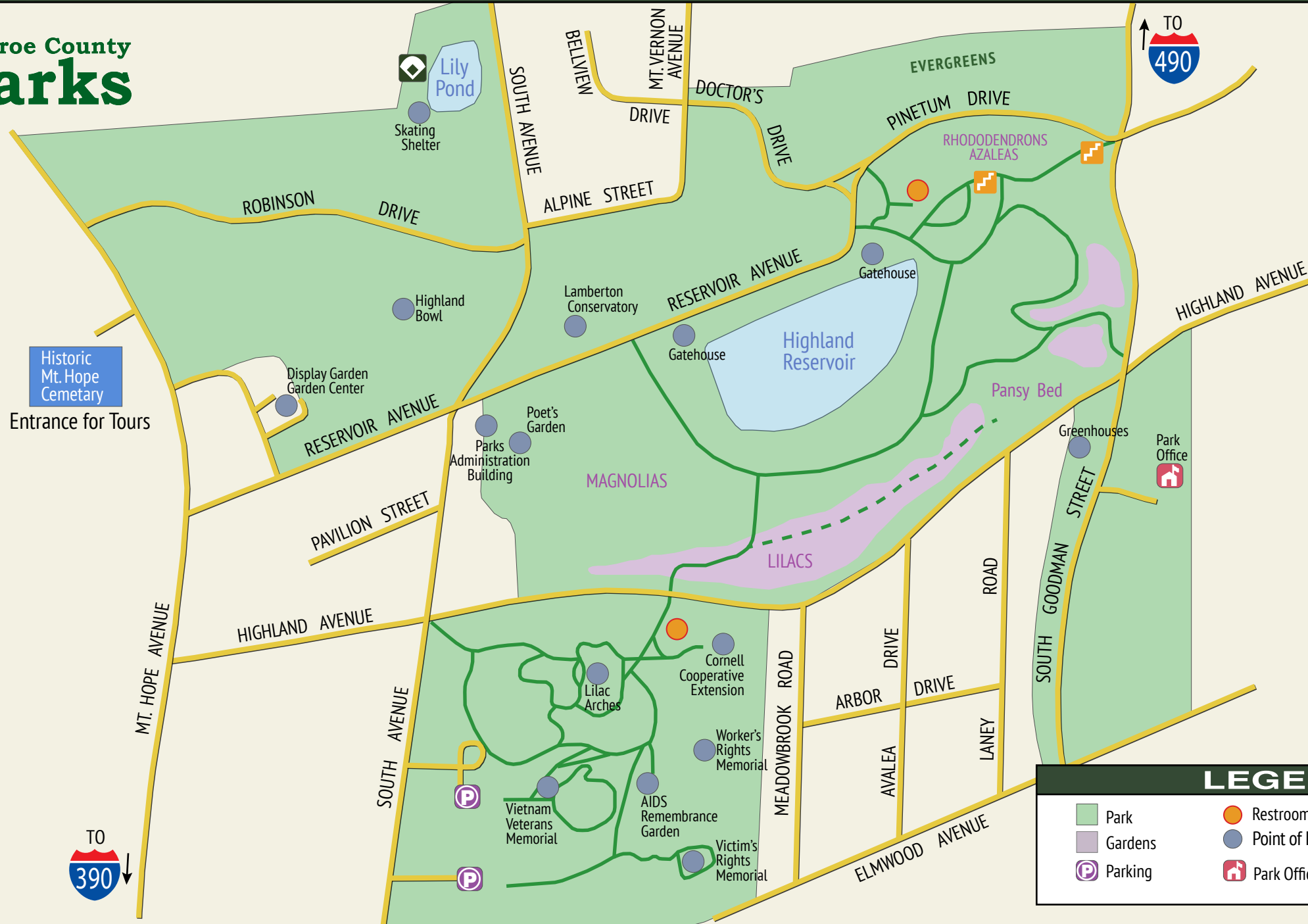

Historic Mt. Hope Cemetary
Entrance for Tours



LEGEND		
Park	Restroom	Walking Path
Gardens	Point of Interest	Staircase
Parking	Park Office	Ball Field

HIGHLAND PARK

Park Office: 585-690-9988

for more information:
monroecounty.gov/parks
585-753-PARK (7275)

PARK HOURS:

- Park Hours are from **6 am until 11 pm.**
- Park access and services vary seasonally, please contact 753- PARK (7275) for more details.

GENERAL PARK RULES:

- **Carry-in Carry-out rule:**
which means you must take all your garbage with you for disposal after leaving the park.
- **All pets must be leashed and you are responsible for cleaning up after them.**

Please be aware of seasonal changes in trail conditions and be prepared for natural conditions such as mosquitoes and poison ivy in some areas.

Trails and Pathways are multiple use, unless noted otherwise. Enjoy walking, running, bicycling, horseback riding and cross-country skiing.

Interested in renting a lodge or shelter?

- Try the online reservation system at monroecounty.gov/parks
or
- Call **585-753-PARK (7275)**

HIGHLAND PARK

Highland park contains various botanical and floral collections including the Poet's Garden, a large number of Azaleas and Rhododendron, the famous Pansy Bed, numerous Evergreens, Magnolias and the nation's largest Lilac Collection.

WARNER CASTLE

Warner Castle and the Castle Garden's landscape were developed as residence for Horatio Gates Warner. The landscape was created by landscape architect, Alling DeForest. The structure and gardens were incorporated into Highland Park in 1951. Warner Castle is now the headquarters of the Rochester Civic Garden Center, a private, non-profit organization which functions as a public, horticulture education resource.

LAMBERTON CONSERVATORY

The Lamberton Conservatory is an indoor, year round plant and floral display. It includes a changing seasonal room, rain forest room, economic plants room, desert and houseplant rooms. There is also a lily pond and stream with goldfish. It is open daily. Call 753-7270 for more details.

LILAC FESTIVAL SITE

Highland Park supports the nation's largest lilac collection and attracts thousands of visitors to the annual Lilac Festival during May. Additional information is available at www.lilacfestival.com

VIETNAM VETERANS MEMORIAL

"To commemorate... To educate... To heal..."

A memorial that commemorates the service, valor, and sacrifice of more than 28,000 Vietnam Veterans from our country region as well as the 280 men who gave the ultimate sacrifice.

AIDS Remembrance Garden

"A place of hope and healing..."

An honorarium to those impacted by AIDS and the HIV virus.

VICTIM'S RIGHTS MEMORIAL

This memorial ensures that crime victims in our community are not forgotten. It offers crime victims and their families a place for quiet reflection, and a place to find comfort, support, inspiration and hope. It stands out as a powerful symbol of Monroe County's commitment to victims of crime.

IRIS FRIENDSHIP GARDEN

This garden was established as a sister cities participation and celebration of Pacific Flora 2004, an international horticulture exposition at Hamamatsu, Japan. The friendship garden features a collection of Louisiana Irises and companion plantings. The educational piece will be the inclusion of the five original species of Louisiana Irises (original parentage). The display bed will include a progression of hybridization of the Iris from species to the most recent cultivated varieties.